

# RUFLEX® Torque limiters

## With sprocket

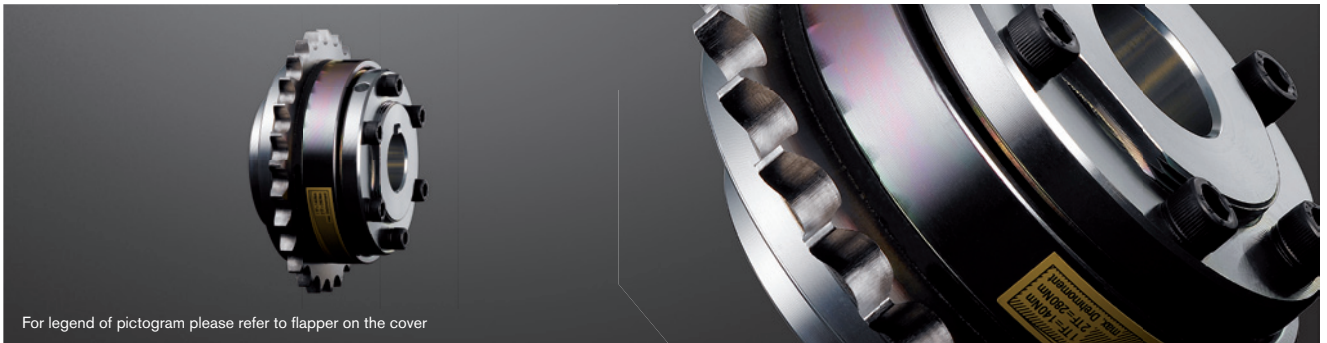

For legend of pictogram please refer to flapper on the cover

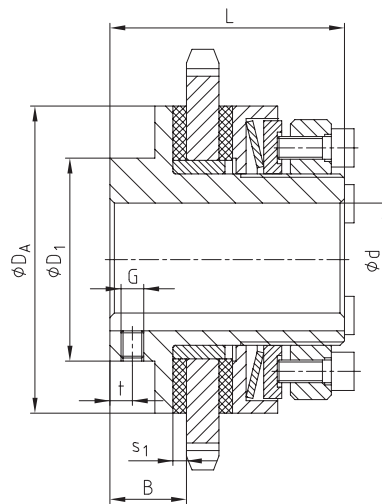
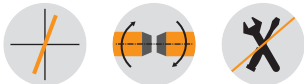

### Technical data – Dimensions

Size	Max. speed <sup>3)</sup> [RPM]	Torques [Nm]			Dimensions [mm]									
		1TF	2TF	3TF <sup>1)</sup>	Max. bore	D <sub>1</sub>	D <sub>A</sub>	B	S <sub>1</sub>	L	t	G	Standard sprocket <sup>2)</sup>	
01	6600	5-35	10-70	–	d	22	40	58	16	3	45	4	M5	06B-1 ( <sup>3</sup> / <sub>8</sub> x <sup>7</sup> / <sub>32</sub> ) z = 23
1	5600	20-75	40-150	130-200	25	45	68	17	3	52	6	M5	08B-1 ( <sup>1</sup> / <sub>2</sub> x <sup>5</sup> / <sub>16</sub> ) z = 22	
2	4300	25-140	50-280	250-400	35	58	88	19	3	57	6	M6	08B-1 ( <sup>1</sup> / <sub>2</sub> x <sup>5</sup> / <sub>16</sub> ) z = 27	
3	3300	50-300	100-600	550-800	45	75	115	21	4	68	6	M6	12B-1 ( <sup>3</sup> / <sub>4</sub> x <sup>7</sup> / <sub>16</sub> ) z = 22	

<sup>1)</sup> With clamping setting nut to be used on types with limited dimensions only

<sup>2)</sup> Minimum number of teeth required / Other sprockets available on request

<sup>3)</sup> See comments on page 230

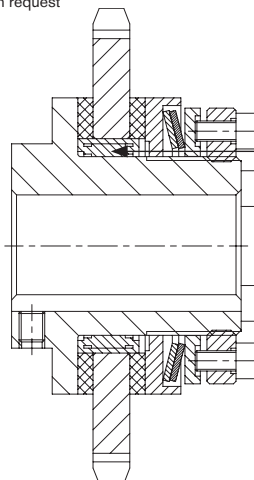

### Special type:

- Available with needle bearing instead of slide bush on request
- For high radial load on the sprocket
- For high speeds or long slipping periods

Ordering example:

RUFLEX® 1	2TF	d Ø20	08B-1 ( <sup>1</sup> / <sub>2</sub> x <sup>5</sup> / <sub>16</sub> ), z=29	100 Nm
Type / size	Disk spring layer	Finish bore	Sprocket	Torque set