

## Standard width of drive component

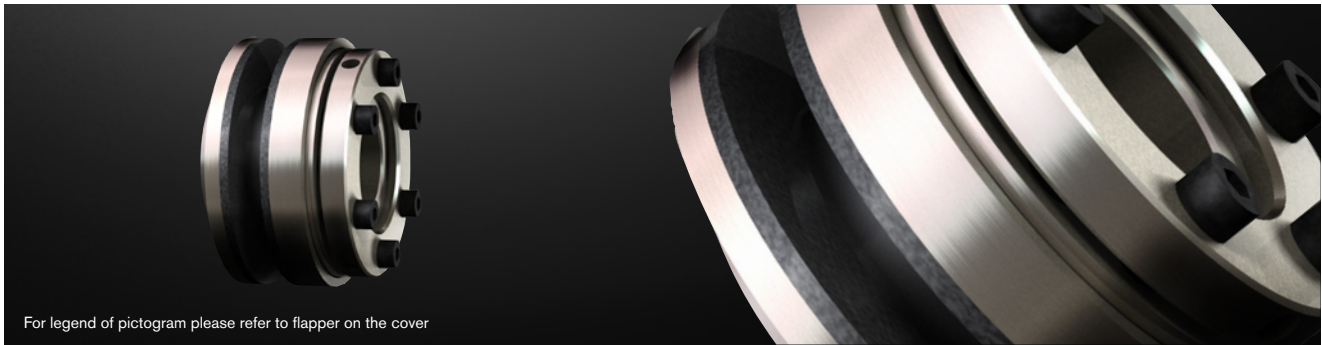

For legend of pictogram please refer to flapper on the cover

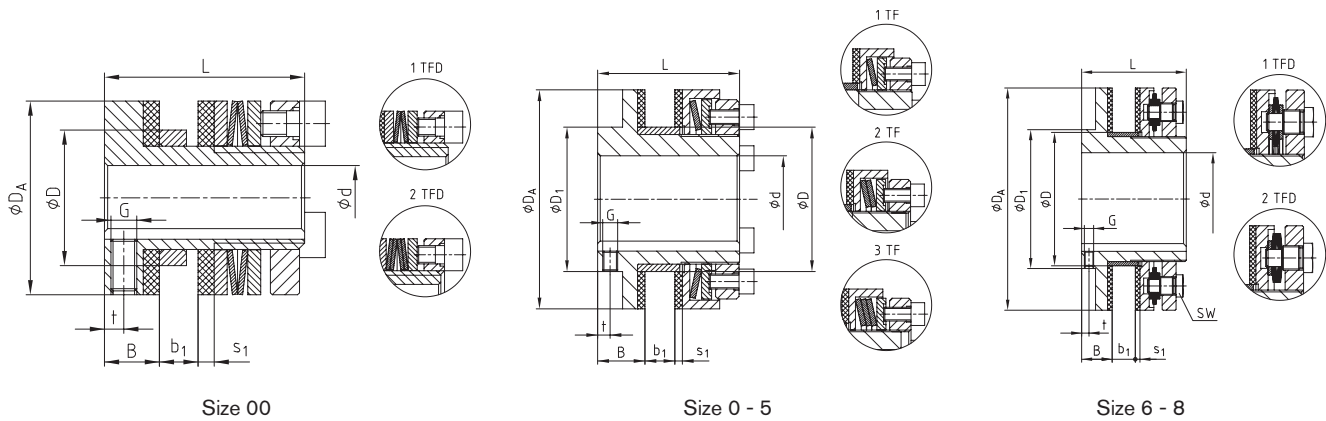
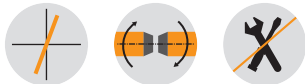

| Technical data – Dimensions |                                |              |           |                   |                 |                  |                                |                |                |     |      |      |                |     |   |     |
|-----------------------------|--------------------------------|--------------|-----------|-------------------|-----------------|------------------|--------------------------------|----------------|----------------|-----|------|------|----------------|-----|---|-----|
| Size                        | Max. speed <sup>4)</sup> [RPM] | Torques [Nm] |           |                   | Dimensions [mm] |                  |                                |                |                |     |      |      |                |     |   |     |
|                             |                                |              |           |                   | Bore d          |                  | Drive component b <sub>1</sub> |                |                |     |      |      | Setscrew       |     |   |     |
|                             |                                | 1TF          | 2TF       | 3TF <sup>3)</sup> | pilot b.        | max.             | D <sup>2)</sup>                | D <sub>1</sub> | D <sub>A</sub> | B   | min. | max. | S <sub>1</sub> | L   | t | G   |
| 00                          | 10000                          | 0,5-3        | 1-5       | –                 | –               | 10               | 21                             | 30             | 30             | 8,5 | 2    | 6    | 2,5            | 31  | 3 | M4  |
| 0                           | 8500                           | 2-10         | 4-20      | –                 | –               | 20 <sup>1)</sup> | 35                             | 45             | 45             | 8,5 | 2    | 6    | 2,5            | 33  | 3 | M4  |
| 01                          | 6600                           | 5-35         | 10-70     | –                 | –               | 22               | 40                             | 40             | 58             | 16  | 3    | 8    | 3              | 45  | 4 | M5  |
| 1                           | 5600                           | 20-75        | 40-150    | 130-200           | –               | 25               | 44                             | 45             | 68             | 17  | 3    | 10   | 3              | 52  | 5 | M5  |
| 2                           | 4300                           | 25-140       | 50-280    | 250-400           | –               | 35               | 58                             | 58             | 88             | 19  | 4    | 12   | 3              | 57  | 5 | M6  |
| 3                           | 3300                           | 50-300       | 100-600   | 550-800           | –               | 45               | 72                             | 75             | 115            | 21  | 5    | 15   | 4              | 68  | 5 | M6  |
| 4                           | 2700                           | 90-600       | 180-1200  | 1100-1600         | –               | 55               | 85                             | 90             | 140            | 23  | 6    | 18   | 4              | 78  | 5 | M8  |
| 5                           | 2200                           | 400-800      | 800-1600  | 1400-2100         | –               | 65               | 98                             | 102            | 170            | 29  | 8    | 20   | 5              | 92  | 8 | M8  |
| 6                           | 1900                           | 300-1200     | 600-2400  | –                 | 38              | 80               | 116                            | 120            | 200            | 31  | 8    | 23   | 5              | 102 | 8 | M8  |
| 7                           | 1600                           | 600-2200     | 1200-4400 | –                 | 45              | 100              | 144                            | 150            | 240            | 33  | 8    | 25   | 5              | 113 | 8 | M10 |
| 8                           | 1300                           | 900-3400     | 1800-6800 | –                 | 58              | 120              | 170                            | 180            | 285            | 35  | 8    | 25   | 5              | 115 | 8 | M10 |

<sup>1)</sup> Finish bore exceeding Ø19, keyway to DIN 6885 sheet 3

<sup>2)</sup> Bore tolerance (drive component): F8 with size 00-4, H8 with size 5-8

<sup>3)</sup> With clamping setting nut, to be used on types with limited dimensions only

<sup>4)</sup> See comments on page 230

On request:

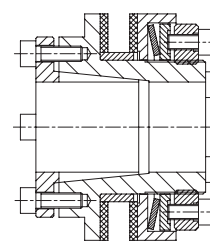
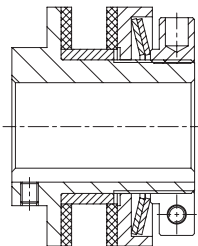

- with clamping setting nut for size 00 – 5. (standard with 3TF)
- for radial torque setting

- with taper bush (hub design 4.5)
- frictionally engaged shaft-hub-connection

|                   |             |                   |   |             |
|-------------------|-------------|-------------------|---|-------------|
| Ordering example: | RUFLEX® 1   | 2TF               | b <sub>1</sub> 10                       | d Ø20       |
|                   | Type / size | Disk spring layer | Width of drive component b <sub>1</sub> | Finish bore |